

PS BOOSTER 120

- ▣ COMPACT
- ▣ LOW MAINTENANCE
- ▣ COMPLETE PACKAGED PUMP STATION
- ▣ SIMPLE INSTALLATION AND OPERATION



SMART DESIGN

- ▣ Mounting space for irrigation controller of your choice*
- ▣ Marine-grade aluminum corrosion-resistant construction
- ▣ External green and red status lights for quick visual indication
- ▣ Removable lid and front panel for full access

EASY INSTALL

- ▣ Forklift-ready skid for easy access lifting points
- ▣ Light-weight (400lbs) design for easy transport

SIMPLE OPERATION

- ▣ Maximum efficient VFD with quick-start guide
- ▣ HOA switch for manual operation
- ▣ Manual pump speed control dial
- ▣ 120 VAC/4 AMP power outlet
- ▣ Pressure drop, 24 VAC pump start relay and flow based (Booster) pump control

SITE APPLICATIONS:

Small sports fields, schools, parks, large residential and commercial

ADDITIONAL BENEFITS

- ✓ Factory tested prior to shipment
- ✓ 1 year warranty
- ✓ UL Listed Packaged Pump Station
- ✓ Built to FCC Part 15 standards
- ✓ 100kA SCCR rating

SPECIFICATIONS

Applications :	Booster, Suction Lift or Flooded Intake
Flow Range :	Up to 120 GPM
Pressure :	Up to 65 PSI (Booster), 60 PSI (Suction Lift)
Horsepower :	5 HP
Voltage	208V/60Hz
(1 or 3 Phase) :	230V/60Hz

LID REMOVED.

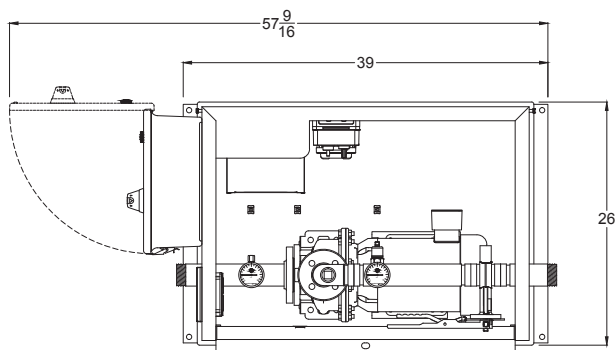

FRONT PANEL REMOVED.

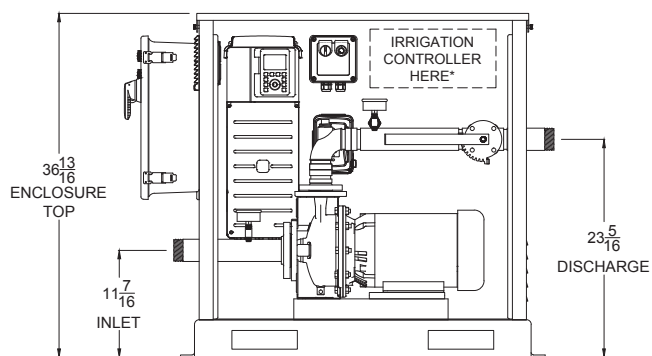

AT SUCTION LIFT HEIGHT OF 10 FEET.

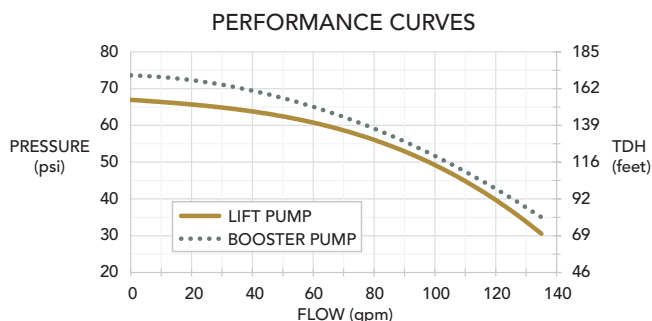

STANDARD FEATURES

- Energy efficient Variable Frequency Drive (VFD) maintains constant pressure at varying flow demand
- Pump control:
 - Pressure drop
 - 24 VAC remote start relay
 - Flow based (Booster)
- UL Type 3R, UL508A listed composite power enclosure with 60 AMP fused disconnect
- 120 VAC/4 AMP power outlet
- Marine grade aluminum station enclosure and base
- Pad-lockable station and power enclosure
- Surge-free starting allows for slow pipe fill at pump start up
- HOA switch for manual and automatic operation
- Manual pump speed control dial
- Stainless steel Horizontal Centrifugal Pump (Booster)/ Self-Priming Horizontal Centrifugal Pump (Suction Lift) both with mechanical seal
- External green system run indicator light
- External red system fault indicator light
- System fault protection alerts:
 - VFD fault shutdown
 - High pump temperature shutdown
 - Motor overload shutdown
 - Transducer failure shutdown
 - Low pressure shut down and pipe break protection
 - High pressure shutdown
 - Phase loss (3 phase only)
 - Loss of prime
 - Pump deadhead shutdown
- 304 stainless steel piping
- Horizontal premium efficient TEFC motor
- 1" priming port
- Pump thermal protection switch
- Stainless steel pressure transducer
- Station enclosure ventilation fan
- Station inlet and discharge pressure gauges
- Threaded NPT inlet and outlet connections
 - Booster: 2" inlet & outlet
 - Suction Lift: 3" inlet & 2" outlet
- Discharge isolation valve
- Low level float switch w/ 50ft cable (Suction Lift)
- 3" foot valve (Suction Lift)
- 2" stainless steel check valve (Booster)

FOR MORE INFORMATION ON THE PS BOOSTER 120, VISIT PUMPSOURCEPRO.COM OR CALL 801.732.5511.

